

Sight glass - Tubular type

with Safety Seal-System, acc. to DIN 28121

NORIS

Bauform 25

Application:

Sightglass - Tubular type with flanges on both sides, to use in either horizontal or vertical pipe lines for optical control of fluids and gasses.

Operating conditions:

Connection: Flanges PN 10/16
 Pressure: up to DN 100 - 6 bar max
 from DN 125 - 4 bar max
 Temperature: 200°C max.

Materials:

1. Flanges: WN 1.4571 | Steel H II
2. Distance-Bars: WN 1.4571 | Steel
5. Screws: A4-70 | Steel
3. Glass tube: Borosilicate glass (DURAN)
4. Gaskets: PTFE covered

Special designs:

Extra length
 Flanges acc. to ANSI
 Protection jacket of acrylic glass

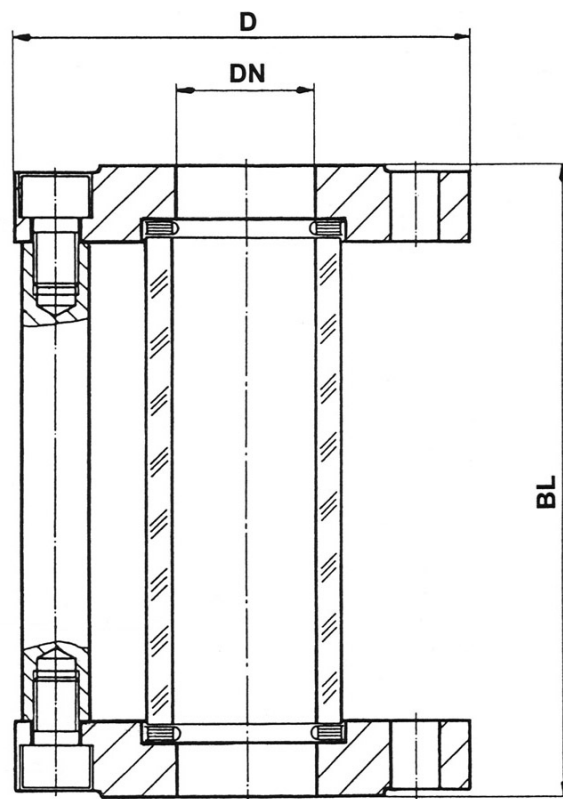

Mounting instructions:

Sight glass tubular type must be mounted without tension by tube, vibrations and pressure pushes.

Dimensions:

DN	D	BL
25	115	160
40	150	200
50	165	230
80	200	310
100	220	350
125	250	400
150	285	480



(Picture with Plexi-jacket)

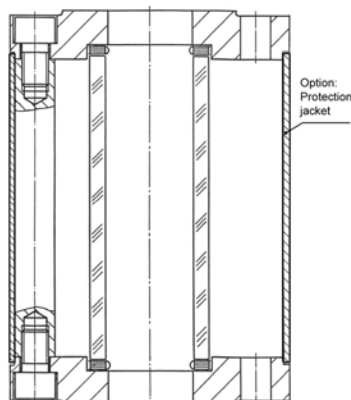

Modifications reserved

上海三盛热能技术有限公司

Shanghai Sansheng ThermalTech Co., Ltd.

地址: 上海市徐汇区漕宝路 70 号光大会展中心 C 座 2501 室 / 200235

电话(Tel): 021-54482938 64326951 64326952

传真 (Fax): 021-54481373

网址: [Http://www.sansheng-sh.com](http://www.sansheng-sh.com)

E-mail: sales@sansheng-sh.com