

Sight Flow Indicators (straight line)

with *butt weld ends* (S) welding design

NORIS

Bauform 108-S

Application:

Sight Flow Indicators are used for optical control and the observation of filling and current in pipelines.

Operating conditions:

Working pressure : 16 bar

Installation:

Optional. Take care of flow direction

Standard Materials:

	108-S-VV	108-S-VS	108-S-St
Body :	1.4435/1.4404	1.4435/1.4404	RSt 37-2
Covers :	Stainless Steel	Steel	Steel
Screws :	A4 - 70	Steel	Steel
Sight glasses:	Borosilicate glass acc. to DIN 7080 (max. 280°C) Soda lime glass acc. to DIN 8902 (max 150°C)		
Gasket :	Graphite (other materials are available on request)		

Options:

Other materials
Flanges connection
Sight glass light-fitting
Spinner or Flap

Ordering example:

Sight flow indicators with butt weld ends
Bauform 108-S-VS
body stainless steel, cover steel
borosilicate glass 16 bar
DN 50 / 60,3

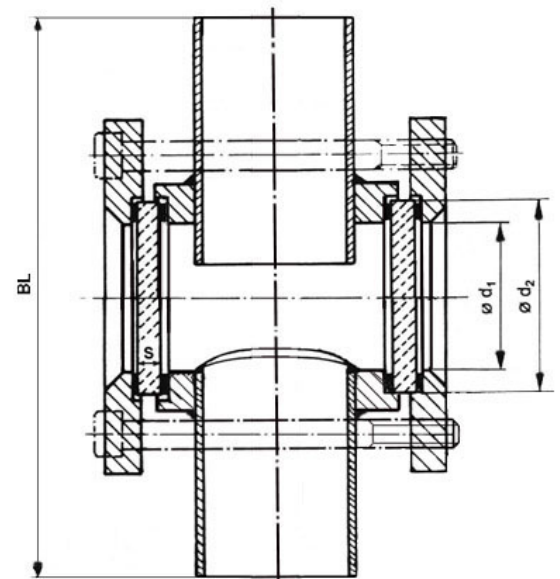

Dimensions:

DN	BL	Glass plate			Screws	Weight ca. Kg
		ø d ₁	ø d ₂	S		
15 / 21,3	124	32	45	10	M 8	1,8
20 / 26,9	144	48	63	10	M 10	2,7
25 / 33,7	154	48	63	10	M 10	2,8
32 / 42,4	174	65	80	12	M 10	4,6
40 / 48,3	194	65	80	12	M 12	4,8
50 / 60,3	224	80	100	15	M 12	6,5
65 / 76,1	284	80	100	15	M 12	7,6
80 / 88,9	304	100	125	20	M 12	11,8

Further sizes on Bauform 112-S

Modification reserved

上海三盛热能技术有限公司

Shanghai Sansheng ThermalTech Co., Ltd.

地址: 上海市徐汇区漕宝路 70 号光大会展中心 C 座 2501 室 / 200235

电话(Tel): 021-54482938 64326951 64326952

传真 (Fax): 021-54481373

网址: [Http://www.sansheng-sh.com](http://www.sansheng-sh.com)

E-mail: sales@sansheng-sh.com